



1GN WALLIGLU WALL MOUNT FREEZER CABINET 2 DOOR WITH WALL MOUNT BRACKETS, LED LIGHTING
Capacity. 243LTR
Temperature Range. -18°C to -15°C @ +43°C

Main Features

Extended Warranty – 5/2yrs Parts and Labour

High-Performance – 55mm high-density (45kg/m³) rigid foam polyurethane insulation, Zero Ozone Depleting – (100% CFC & HCFC Free)

+43°C Ambient (T Class) – all cooling, mechanical components are engineered to perform reliably in a tropicalized climate of +43°C ambient

Adaptive Precision Controller – adaptive and remarkably flexible IP65 Water & Dust Ingress Protected 'Intelligent' controller with (LCD) Liquid Crystal Display for clear text monitoring of temperatures, functions, cycles, alarms, compressor running, defrost cycle, dripping indicator, temperature & humidity level indicator, cooling, door open alarm, and clean condenser. Built-in features include; audible and visual multi-function alarm alert system, fan speed management system, auto self-diagnostics system, and Intelligent Defrost System

Intelligent Defrost Systems (IDS) – demand responsive, reliable and highly-efficient 'hot-gas' defrost eliminating the need for extra energy input will only initiate when necessary & only when necessary without consideration of previous defrost cycles and without the need for predetermined time-based defrost intervals

AISI304 Construction – entirely constructed of AISI304 high-grade-food-safe stainless steel externally and internally featuring a mirror polished interior with a coved ceiling and floor base and radius corners (R=12) both top and bottom. Easy 'tool free' removable shelving system for cleaning is in AISI304 stainless

High-efficiency Refrigeration Systems – left-side mounted side mounted high-performance electronic controlled integral refrigeration system, entirely front ventilating refrigeration and electrics, condenser & evaporator/s with high exchange surface area for maximum output of refrigeration cycles, entire refrigeration system mounted on 'slide-out' guides to facilitate ease of maintenance and service

High Exchange Evaporators / 'IQ' Cooling Fans – protected by food safe coating and AISI304 stainless steel shroud are positioned within the dead space rear of the door mullion/s for highly efficient cooling and perfect homogeneity

Solid Panel Doors – reversible AISI304 insulated stainless panel door with radius handle, self-closing at less than 90° with 'stop' (remains open unassisted) at 95°

Entirely Front Breathing – entirely front ventilating system to allow for installation hard-up against the rear, left side technical compartment side walls and ceiling

Door Frame Heater – to eliminate condensation on and around the door fascia

Auto Self-diagnostics – is self-adjusting to ambient and operational conditions, continually accesses the performance of the refrigeration system and efficiency

Inbuilt Defrost Waste Vaporizer – hot-gas disposal device to eliminate the defrost water (drainage not required)

Over-current / Thermal Fuse Protection – inbuilt thermal protection in the event of a thermal compromise to prevent, and limit damage to equipment's electrical components and reduce the risk of harm to the operator caused by overloads, or electrical safety breaches in unusual circumstances

Service & Maintenance – facilitated via electronic controller to report a precise log of operating temperatures, cycles & alarm event history available in real time to service technicians, self-diagnostic test can be launched to ensure parameters are correct set to guarantee optimum operating capacity upon servicing/maintenance

Manufacturer Warranty. 5 Years Parts & 2 Years Labour
Temperature Range. -18°C to -15°C
Rated Ambient Class. +43°C (T Class)
Internal Capacity. 243LTR
Origin. Italy

Model PC.2V

Electrical Specification

Supply voltage / Frequency. 240V / 50Hz / 1Ph
Connection rating. 2.2Amps
Connected load. 528Watts - 0,52kW

Key Information: Integral Versions (R404a)

Internal volume. 243 litres
Number door/s. 2
Type of door. (stainless steel) Insulated panel
Door hinged. Left / Right hand side
Drainage. Not required
Minimum temperature set point. -18°C
Maximum temperature set point. -15°C
Ambient class. +43°C (T Class)
Adjustable humidity (adjustable in 1% increments). N/A
External dimensions, Width. 1620mm
External dimensions, Depth. 450mm
External dimensions, Height. 660mm
Door width x height. (mm) 635Wx648D
Overall depth with Door/s open. 1070mm
Insulation thickness. 50mm
Insulation density. 45kg/m³
Number of Shelves & Shelf Size. (mm) (4) x 325Wx530D
Type of external material. AISI304 Cr Ni 18/10
Type of internal material. AISI304 Cr Ni 18/10
100% entirely front breathing. Yes

Refrigeration Data (R404a)

Controller type. Electronic
Refrigerant type. R404a
Refrigerant Gas Quantity. 460grams
Compressor power. 3/4hp
Cooling Capacity @ +43°C. 490Watts
Cooling Capacity @ +32°C. 545Watts
Evaporator Temp. -30°C
Cooling system type. Ventilated Forced Air
Defrost type. IDS
Defrost waste disposal. Auto-disposal
Net / Shipped Weight. 90kg / 106kg

Marks of Conformity

HACCP Certified, 2006/42/CE, NF, EN 60335-1, EN 60335-2-89, EN 55014-1, EN55014-2, EN 61000-3-2, EN 61000-3-3, 2004/108/CE, RoHS, RAEE, WEEE, REACH

Included Accessories

Number of shelves included. 4
Wall mount brackets. Included
LED internal lighting. Included

Versions Available

Remote. (without inbuilt refrigeration unit) PCR.2V
Triple Glazed Argon E Heated Tempered Safety Glass Door PC.2PV
Refrigerated Version PR.2V
Remote Refrigerated PRR.2V
Refrig Double Glazed Argon E Tempered Safety Glass Door PR.2PV

| Optional Accessories | |
|----------------------|-----------------------------------------------------------|
| KWS | Mechanical Key Lock/s (per door) |
| KSC.M | Electronic Door/s Locks (password protected) |
| NEON | Neon Lighting |
| CG.9 | AISI304 Stainless Steel Hanging Rail with 9 Hooks |
| KNI.2 | Task Light (mounted on underside over bench top) |
| RGI.G | Stainless Steel Shelf |
| RGIG.G | Rilsan Shelf |
| RBF | Perforated Flat AISI304 Stainless Shelf |
| CGG.P | AISI304 stainless 'L' shaped shelf guides (pair) |
| TSB.16 | Bearing Structure for Bench Top Mounting |
| KSC.M | Electronic Door/s Locks (password protected) |
| PVBT | Triple Glazed Argon E Heated Tempered Safety Glass Door/s |
| R404a | R404a refrigerant gas |
| CO2 | Transcritical (for remote counters only) |

Remote Counter Data & Notes

Refrigeration Duty: 370Watts @ -30°C (minimum power required/suggested)

Remote Connections:

- A - Drain (defrost waste) Ø 20mm
- B - Exit tube evaporator (suction tube) Ø 8mm
- C - Entry tube evaporator (liquid line) Ø 6mm
- D - Power lead 10Amp 3 pin

A - *auto disposal device fitted as standard - unless otherwise specified*

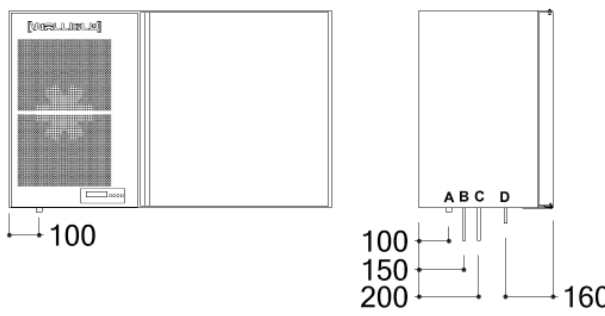

SERVICES LAYOUT

END VIEW

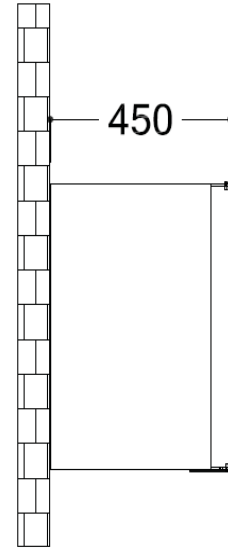

TOP VIEW

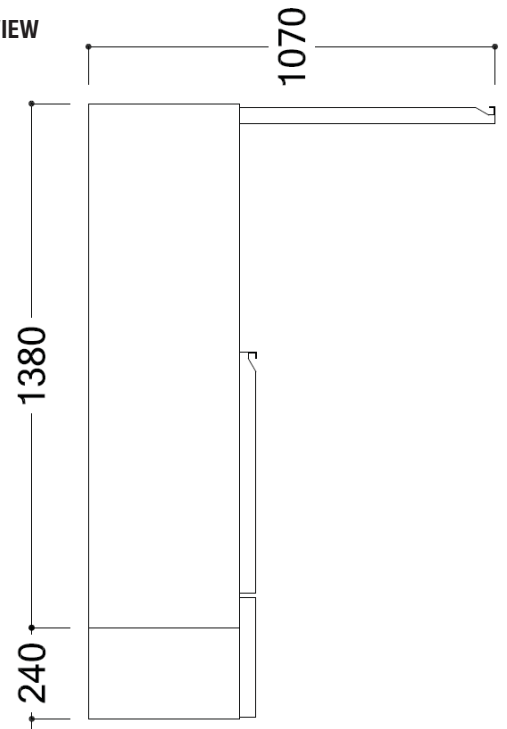

FRONT VIEW

